

STATE OF CALIFORNIA
DEPARTMENT OF TRANSPORTATION
PROJECT PLANS FOR CONSTRUCTION ON
INTERSTATE 10 & RAMSEY ST

Dist	COUNTY	ROUTE	POST MILES TOTAL PROJECT	SHEET No.	TOTAL SHEETS
8	Riv	10	N/A		X

REGISTERED CIVIL ENGINEER DATE _____

PLANS APPROVAL DATE _____

THE STATE OF CALIFORNIA OR ITS OFFICERS OR AGENTS SHALL NOT BE RESPONSIBLE FOR THE ACCURACY OR COMPLETENESS OF SCANNED COPIES OF THIS PLAN SHEET.

CALTRANS, District 8
464 W 4th St
San Bernardino, CA 92401

REVISOR: _____ DATE: _____

DESIGNED BY: _____ CHECKED BY: _____

CONSULTANT: _____ SUPERVISOR: _____

STATE OF CALIFORNIA - DEPARTMENT OF TRANSPORTATION

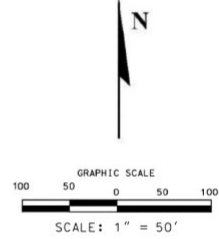
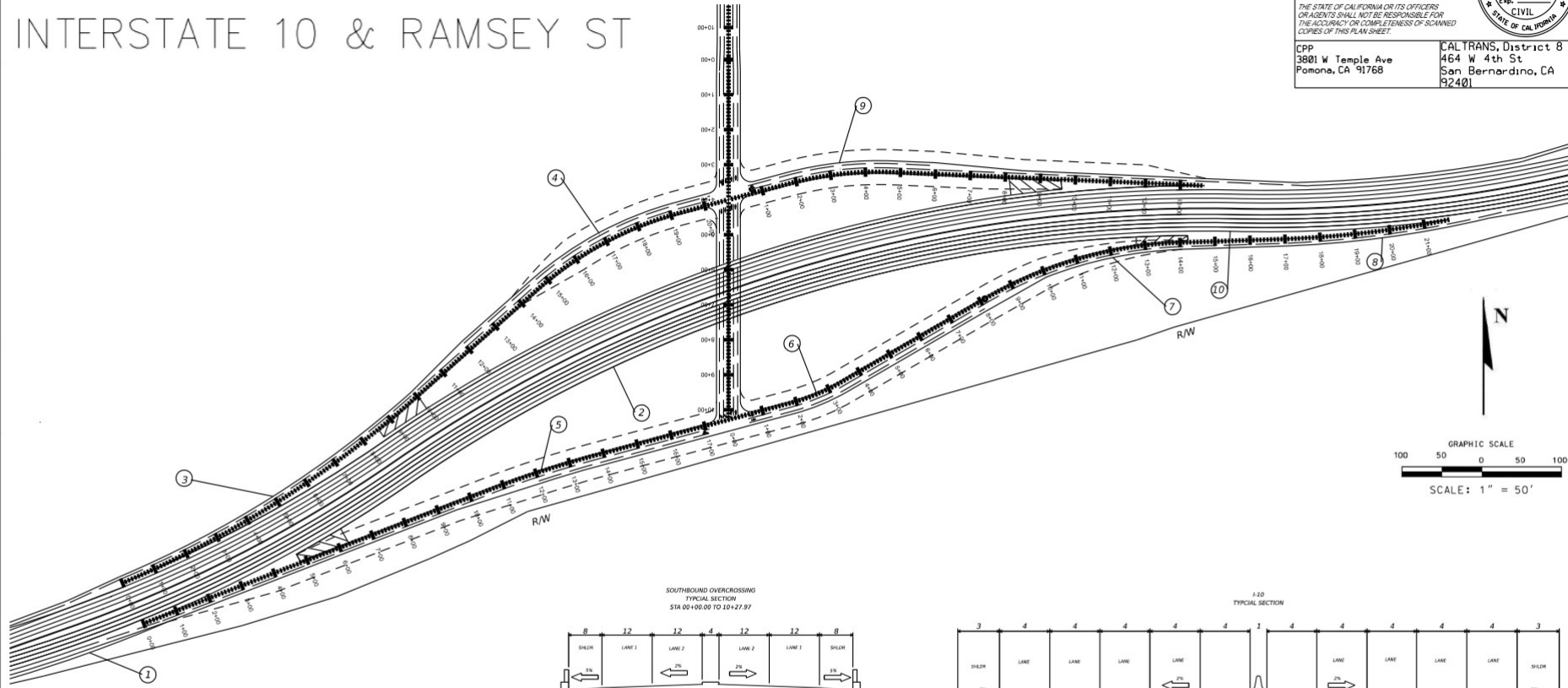

No.	R	L	Δ	T
1	4000	1273	18.24	641.6
2	4000	2493	35.71	1288.6
3	3000	1011	19.02	510.16
4	1000	464.21	26.59	236.36
5	3000	321.68	6.14	160.99
6	600	158.09	15.09	79.5
7	1200	591.72	28.25	302
8	3000	501.85	9.86	251.5
9	1000	304.66	17.46	153.5
10	4000	1253.91	17.96	632.1

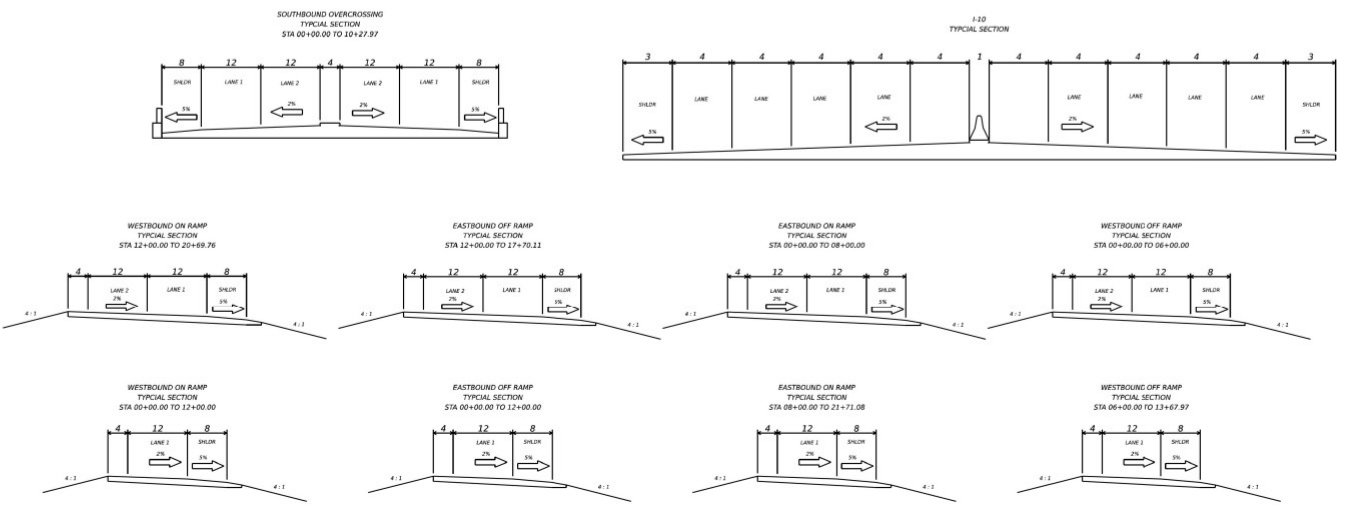

LATEST REVISION: DATE PLOTTED -> NOTE
00-00-00 TIME PLOTTED -> 8:16

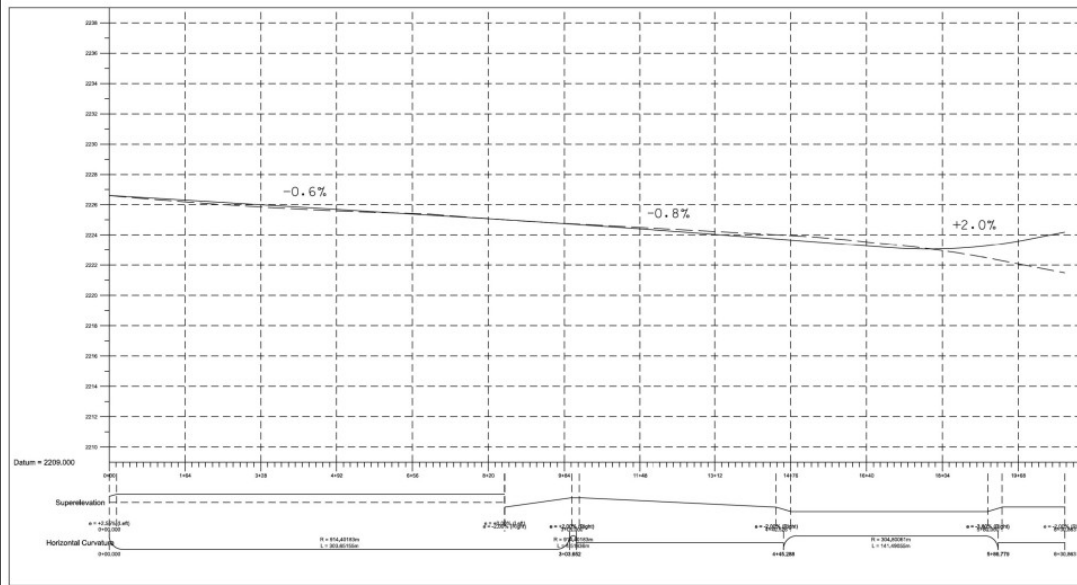

WESTBOUND ON RAMP

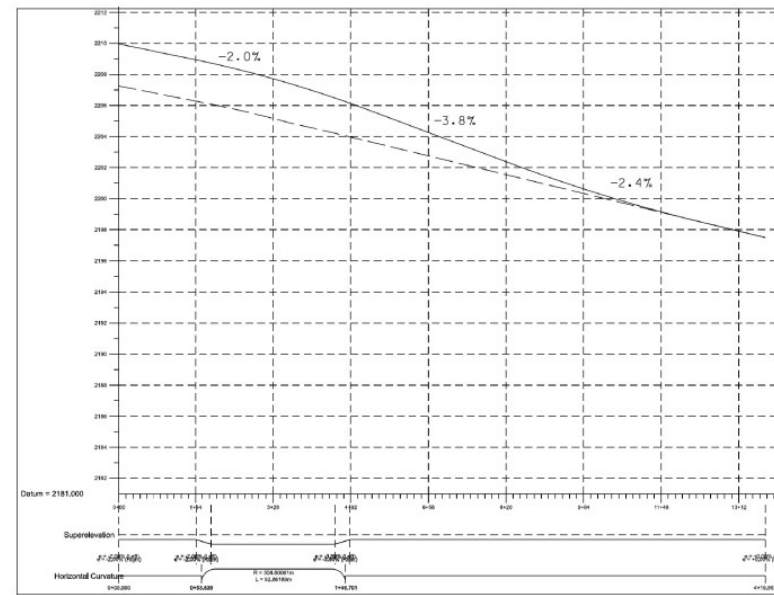

WESTBOUND OFF RAMP

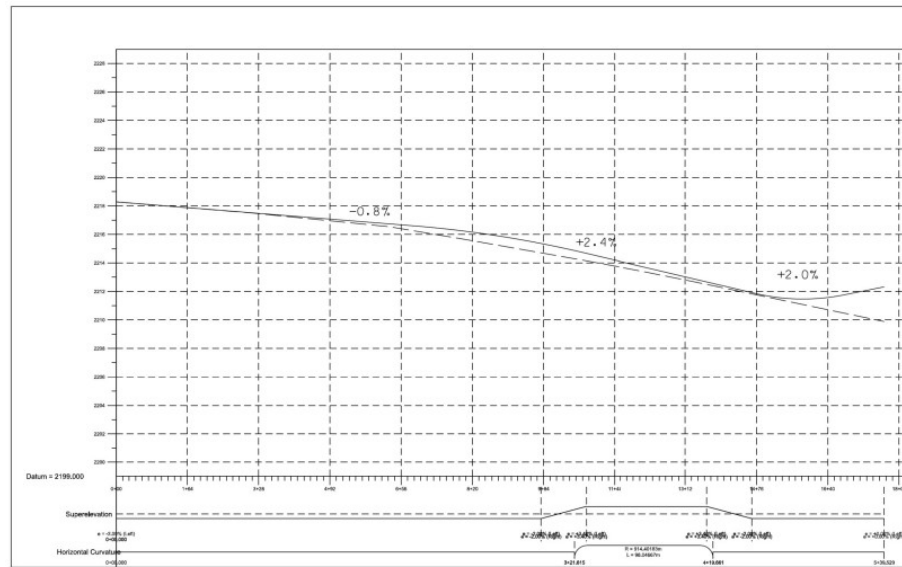

EASTBOUND OFF RAMP

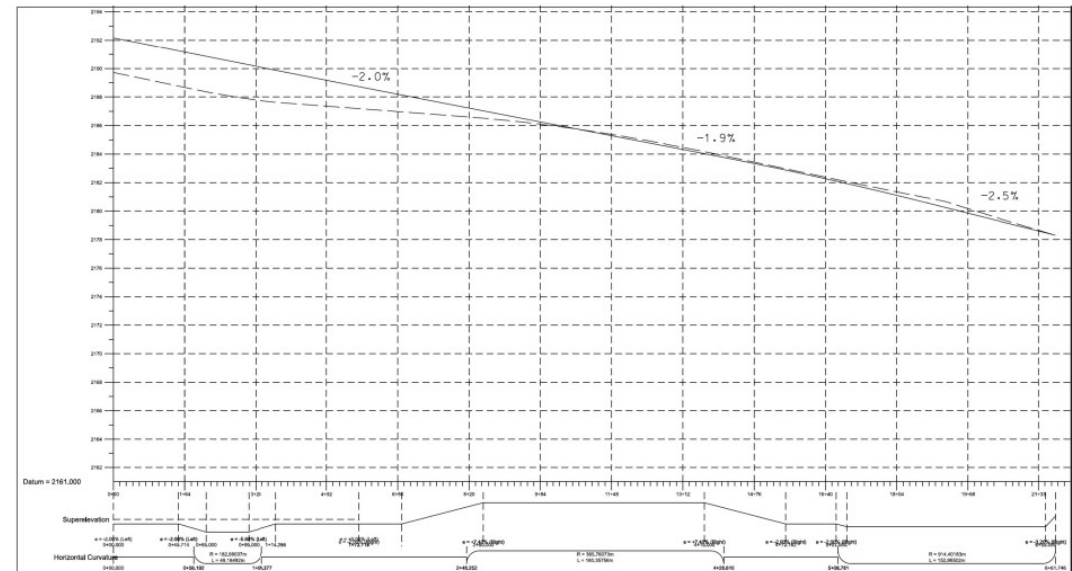

EASTBOUND ON RAMP

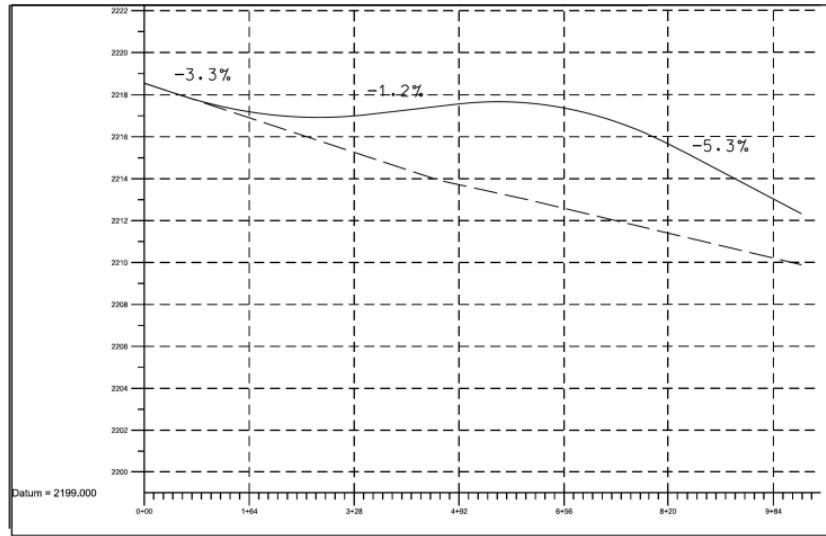

E. RAMSEY OVERCROSSING

I-10 ADJUSTED

